

Screw driver notch for lens removal 2 Plcs

Aluminum Stamping
Clear Coat Aluminum,
Brushed Aluminum,
Chrome Plated

Lens is made from
a high performance
diffuse acrylic material

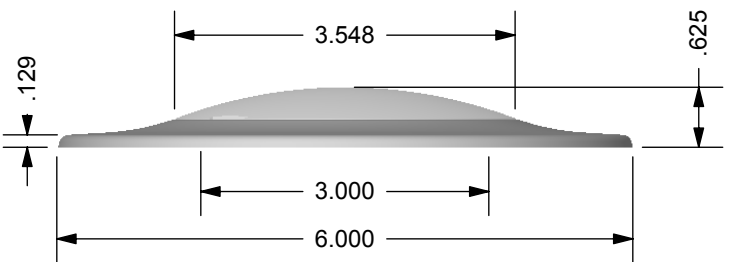

- Notes:
1. Operating Voltage is 13.6VDC
 2. Drive current for white LED's will be .6A
 3. Drive current for optional Red LED's is .4A
 4. Wire will be 20AWG, color coded according to LED color
 5. Use 2 #8 Oval Head Phillips screw.

CONFIDENTIAL

THE INFORMATION CONTAINED IN THIS DRAWING IS THE SOLE PROPERTY OF Dragonfish Technologies LLC. ANY REPRODUCTION IN PART OR WHOLE WITHOUT THE WRITTEN PERMISSION OF Dragonfish Technologies LLC IS PROHIBITED.

ITEM NO.	PART OR IDENTIFYING NO.	NOMENCLATURE OR DESCRIPTION	MATERIAL SPECIFICATION	QTY REQD
PARTS LIST				
UNLESS OTHERWISE SPECIFIED DIMENSIONS ARE IN INCHES TOLERANCES ARE:		CAD GENERATED DRAWING BY: DRAGONFISH TECHNOLOGIES LLC		TecNiq inc
DECIMALS .XX ±0.005 .XXX ±0.003		APPROVALS DATE		
ANGLES X° ±0.5° X.X° ±0.1°		DRAWN MBP 8/20/2009		Orion Interior Light
MATERIAL NA		CHECKED		
FINISH --		RESP ENG		
DO NOT SCALE DRAWING		MFG ENG		SIZE A DWG. NO. Temp
		QUAL ENG		REV. 0
		SCALE 1		CAD FILE: SHEET 1 OF 1