

# D06

## STEP & ACCENT LIGHT



### Technical features

- ✦ Perfect for accent, steps, walkways
- ✦ IP68 rated – Water and dust proof
- ✦ UV Resistant, automotive exterior lighting grade polycarbonate
- ✦ Durable impact resistant lens
- ✦ Exceeds FMVSS 108 standards
- ✦ Surface mount installation with two fasteners
- ✦ Life performance: 100,000 hours

### Specifications

Dimensions	2."x1"x0.85" (see diagram)
LED's	1
Current	0.11A-0.14A
Connector	9" Sheathed
Mounting	Mounts using (2) screws. $\phi$ 0.15" screw hole
LED colors	White
Lumens	115

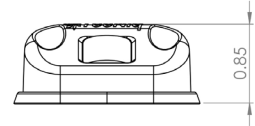
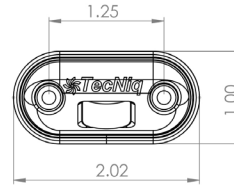

#### California Proposition 65

WARNING: This product can expose you to chemicals including lead, which is known to the State of California to cause cancer, birth defects or other reproductive harm

Part Numbers	Description	Std. Pack	Connector
D06-0G00-1	Step Light 45 Deg. Gasket	100	-
D06-WC00-1	Step Light White 45 Deg. W/Chrome Case	100	Sheathed Pigtail

